

Plan of Land in  
Gay Head, Mass.

Surveyed for  
**REBECCA J. COURNOYER, MARY E. COURNOYER**

September 4, 1990 scale 1 in. = 80 ft.  
Vineyard Land Surveying  
Box 258  
Vineyard Haven, MA 02568

Error of Closure 1 in 105,737  
Linear Error 0.046'  
Direction of Error N31°31'32"W

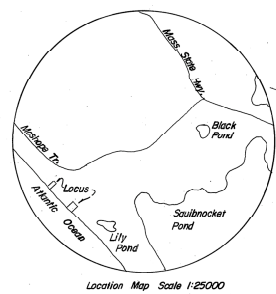
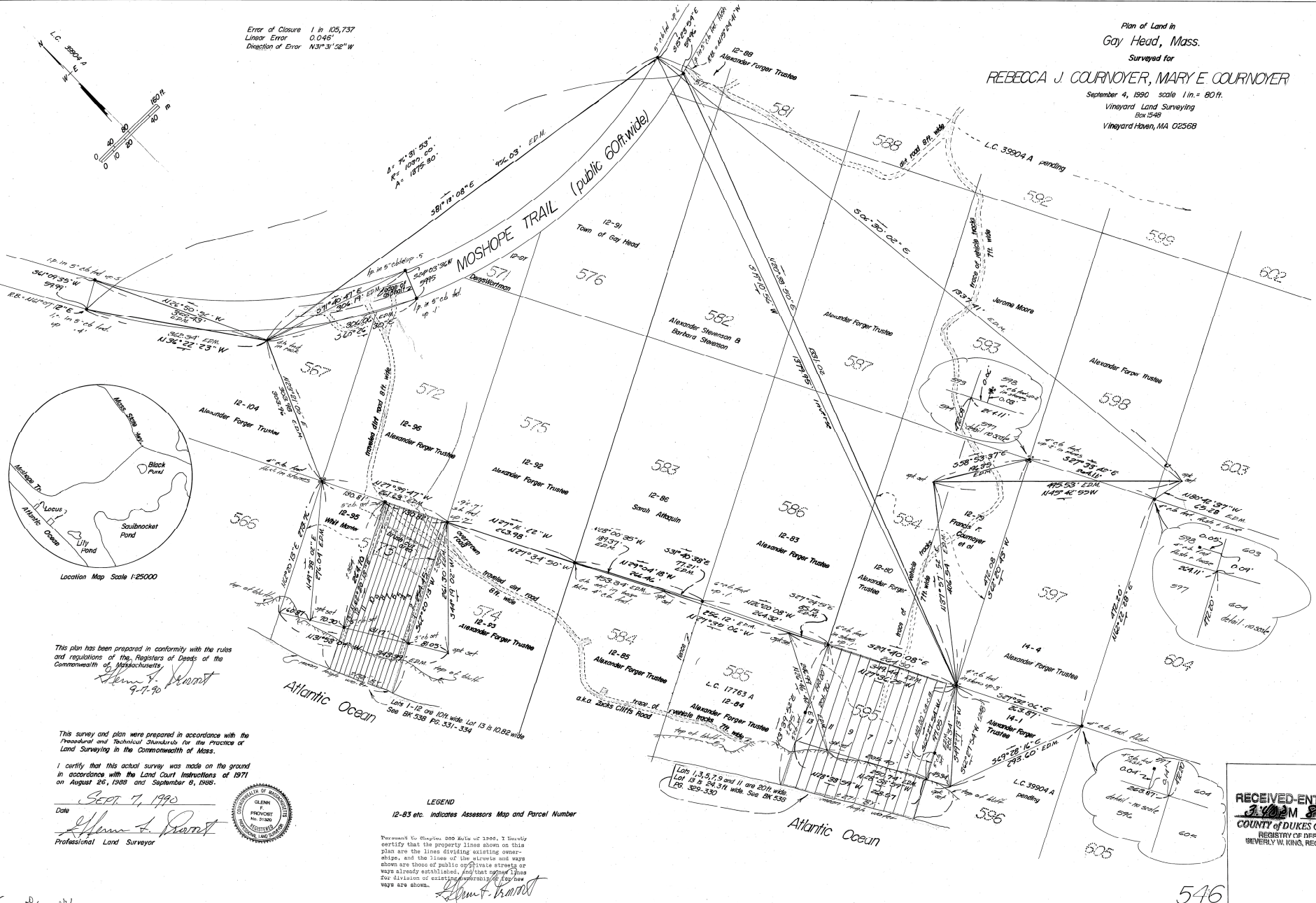
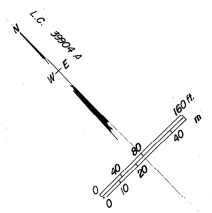

Location Map Scale 1:25000

This plan has been prepared in conformity with the rules and regulations of the Registrars of Deeds of the Commonwealth of Massachusetts  
*Glenn F. Provost*  
9.7.90

This survey and plan were prepared in accordance with the Precedent and Technical Standards for the Practice of Land Surveying in the Commonwealth of Mass.

I certify that this actual survey was made on the ground in accordance with the Land Court Instructions of 1971 on August 26, 1988 and September 8, 1988.

Sept 7, 1990  
*Glenn F. Provost*  
Professional Land Surveyor



LEGEND  
12-83 etc. indicates Assessors Map and Parcel Number

Pursuant to Chapter 260B of the Laws of 1980, I hereby certify that the property lines shown on this plan are the lines dividing existing ownership, and the lines of the streets and ways shown are those of public or private streets or ways already established, and that proper lines for division of existing ownership or for new ways are shown.  
*Glenn F. Provost*

RECEIVED-ENTERED  
310 PM 8-22-92  
COUNTY OF DUKES COUNTY  
REGISTRY OF DEEDS  
BEVERLY W. KING, REGISTER